3 Bogen
3 bends

Ergänzend zu unserem Katalogprogramm liefern wir auch

- Schwenkbogen
- Molchbogen
- sowie Bogen mit abweichenden Radien

Beachten Sie auch die orbitalschweißfähigen Bogen höchster Oberflächengüte aus unserem PharmCom- und HyCom-Programm in Produktgruppe 10!



Bogen
Bends

Additionally to our catalogue programme we deliver as well

- swivel bends
- bends for pigging pipelines
- and bends with differing radius

Please take a look at our bends of highest surface finish which are orbital weldable and belong to our PharmCom- and HyCom-programme in product group 10!

3.01 Schweißbogen

3.01 welding bend

Art.-Nr. 32200-							AISI 304L-1.4307				AISI 316L-1.4404			
DN	A	B	C	D	E	Gew.	Art.-Nr.	Preis	Art.-Nr.	Preis	Art.-Nr.	Preis	Art.-Nr.	Preis
mm	mm	mm	mm	mm	mm	kg	poliert	EUR	matt/wb	EUR	poliert	EUR	matt/wb	EUR
10	26,0	9,0	12,0	26,0		0,010	-0101	5,05	-0102	4,10	-0103	5,85	-0104	4,60
15	35,0	15,0	18,0	35,0		0,030	-0151	5,65	-0152	4,30	-0153	5,90	-0154	4,50
20	40,0	19,0	22,0	40,0		0,040	-0201	5,10	-0202	4,50	-0203	6,05	-0204	5,10
25	50,0	25,0	28,0	50,0		0,070	-0251	7,10	-0252	4,60	-0253	8,60	-0254	5,80
32	55,0	31,0	34,0	55,0		0,100	-0321	8,10	-0322	5,35	-0323	9,65	-0324	7,15
40	60,0	37,0	40,0	60,0		0,130	-0401	8,70	-0402	5,70	-0403	11,00	-0404	7,75
50	70,0	49,0	52,0	70,0		0,200	-0501	10,45	-0502	7,20	-0503	13,05	-0504	9,15
65	80,0	66,0	70,0	80,0		0,350	-0651	17,65	-0652	10,75	-0653	22,00	-0654	15,85
80	90,0	81,0	85,0	90,0		0,540	-0801	28,85	-0802	17,95	-0803	35,55	-0804	25,05
100	100,0	100,0	104,0	100,0		0,730	-1001	38,10	-1002	25,05	-1003	49,10	-1004	31,70
125	187,5	125,0	129,0	187,5		1,780	-1251	94,65	-1251001	56,00	-1253	125,30	-1253001	74,15
150	225,0	150,0	154,0	225,0		2,680	-1501	116,30	-1501001	67,50	-1503	155,95	-1503001	99,70
200	300,0	200,0	204,0	300,0		4,720	-2001	189,25	-2001001	114,95	-2003	194,30	-2003001	135,50

**Schweißbogen
DIN 90°**

**welding bend
DIN 90°**

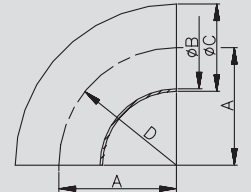

DN65-200 gem. DIN 11852-BS 90°

DN65-200 acc. DIN 11852-BS 90°

DN125-200 matt gestrahlt auf Anfrage - wb: walzblank

DN125-200 mat blasted on inquiry - wb: bright-rolled

Art.-Nr. 32202-							AISI 304L-1.4307				AISI 316L-1.4404			
DN	A	B	C	D	E	Gew.	Art.-Nr.	Preis	Art.-Nr.	Preis	Art.-Nr.	Preis	Art.-Nr.	Preis
mm	mm	mm	mm	mm	mm	kg	poliert	EUR	matt	EUR	poliert	EUR	matt	EUR
10	17,0	9,0	12,0	26,0		0,008	-0101	4,05	-0102	3,10	-0103	4,70	-0104	3,45
15	24,0	15,0	18,0	35,0		0,018	-0151	4,60	-0152	3,25	-0153	4,80	-0154	3,40
20	27,0	19,0	22,0	40,0		0,025	-0201	4,00	-0202	3,40	-0203	4,80	-0204	3,85
25	34,0	25,0	28,0	50,0		0,037	-0251	5,95	-0252	3,45	-0253	7,15	-0254	4,35
32	37,0	31,0	34,0	55,0		0,050	-0321	6,80	-0322	4,05	-0323	7,90	-0324	5,40
40	41,0	37,0	40,0	60,0		0,070	-0401	6,75	-0402	3,75	-0403	8,30	-0404	5,05
50	48,0	49,0	52,0	70,0		0,100	-0501	7,95	-0502	4,70	-0503	9,85	-0504	5,95
65	55,0	66,0	70,0	80,0		0,200	-0651	13,90	-0652	7,00	-0653	16,50	-0654	10,35
80	62,0	81,0	85,0	90,0		0,285	-0801	21,70	-0802	10,80	-0803	25,55	-0804	15,05
100	69,0	100,0	104,0	100,0		0,380	-1001	28,10	-1002	15,05	-1003	36,45	-1004	19,05
125	131,0	125,0	129,0	187,5		0,890	-1251	72,25	-1252	33,60	-1253	95,65	-1254	44,50
150	157,0	150,0	154,0	225,0		1,340	-1501	89,30	-1502	40,50	-1503	116,10	-1504	59,85
200	209,0	200,0	204,0	300,0		2,360	-2001	154,80	-2002	80,50	-2003	153,65	-2004	94,85

**Schweißbogen
DIN 45°**

**welding bend
DIN 45°**

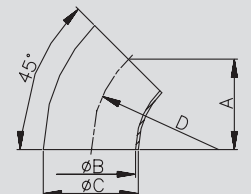

DN65-200 gem. DIN 11852-BS 45°

DN65-200 acc. DIN 11852-BS 45°

Art.-Nr. 32220-							AISI 304L-1.4307				AISI 316L-1.4404			
DN	A	B	C	D	E	Gew.	Art.-Nr.	Preis	Art.-Nr.	Preis	Art.-Nr.	Preis	Art.-Nr.	Preis
mm	mm	mm	mm	mm	mm	kg	poliert	EUR	matt	EUR	poliert	EUR	matt	EUR
10	26,0	10,0	13,0	26,0		0,010					-0103	7,10	-0104	5,70
15	35,0	16,0	19,0	35,0		0,030					-0153	7,15	-0154	5,80
20	40,0	20,0	23,0	40,0		0,040					-0203	7,95	-0204	6,45
25	50,0	26,0	29,0	50,0		0,050	-0251	7,35	-0252	4,90	-0253	9,35	-0254	6,60
32	55,0	32,0	35,0	55,0		0,080	-0321	8,55	-0322	5,75	-0323	10,25	-0324	8,15
40	60,0	38,0	41,0	60,0		0,100	-0401	9,05	-0402	6,15	-0403	11,80	-0404	8,55
50	70,0	50,0	53,0	70,0		0,170	-0501	11,00	-0502	7,95	-0503	14,20	-0504	9,95

**Schweißbogen
DIN 11852-BS 90°**

**welding bend
DIN 11852-BS 90°**

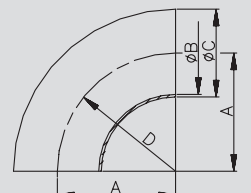

DN65-200 siehe Art.-Nr. 32200

DN65-200 see item-no. 32200

3.02 Schweißbogen

3.02 welding bend

Schweißbogen
DIN 11852-BS 45°

welding bend
DIN 11852-BS 45°

Art.-Nr. 32222-

DN	A	B	C	D	E	Gew.	AISI 304L-1.4307				AISI 316L-1.4404			
							Art.-Nr.	Preis	Art.-Nr.	Preis	Art.-Nr.	Preis	Art.-Nr.	Preis
mm	mm	mm	mm	mm	mm	kg	poliert	EUR	matt	EUR	poliert	EUR	matt	EUR
10	17,0	10,0	13,0	26,0		0,005					-0103	5,70	-0104	4,30
15	23,0	16,0	19,0	35,0		0,015					-0153	5,70	-0154	4,35
20	27,0	20,0	23,0	40,0		0,020					-0203	6,35	-0204	4,85
25	34,0	26,0	29,0	50,0		0,025	-0251	6,15	-0252	3,70	-0253	7,70	-0254	4,95
32	37,0	32,0	35,0	55,0		0,040	-0321	7,15	-0322	4,35	-0323	8,25	-0324	6,15
40	41,0	38,0	41,0	60,0		0,050	-0401	6,90	-0402	4,00	-0403	8,85	-0404	5,60
50	48,0	50,0	53,0	70,0		0,085	-0501	8,25	-0502	5,20	-0503	10,75	-0504	6,50

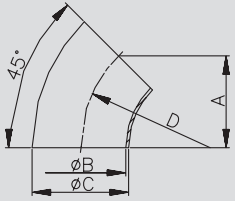

DN65-200 siehe Art.-Nr. 32202

DN65-200 see item-no. 32202

Schweißbogen
Zoll 90°

welding bend
inch 90°

Art.-Nr. 32601-

DN	A	B	C	D	E	Gew.	AISI 304L-1.4307				AISI 316L-1.4404			
							Art.-Nr.	Preis	Art.-Nr.	Preis	Art.-Nr.	Preis	Art.-Nr.	Preis
mm	mm	mm	mm	mm	mm	kg	poliert	EUR	matt	EUR	poliert	EUR	matt	EUR
1"	27,5	22,9	25,4	27,5		0,085	-1001	9,95	-1002	6,75	-1003	14,15	-1004	11,05
1,5"	45,0	35,1	38,1	45,0		0,240	-1121	14,80	-1122	10,10	-1123	23,40	-1124	17,65
2"	67,5	47,8	50,8	67,5		0,380	-2001	18,00	-2002	11,50	-2003	27,40	-2004	21,25
2,5"	82,5	60,2	63,5	82,5		0,570	-2121	25,95	-2122	17,25	-2123	40,85	-2124	30,15
3"	95,0	72,8	76,1	95,0		1,075	-3001	40,50	-3002	26,40	-3003	58,55	-3004	38,95
4"	133,5	97,4	101,6	133,5		1,240	-4001	81,10	-4002	51,55	-4003	106,35	-4004	72,25

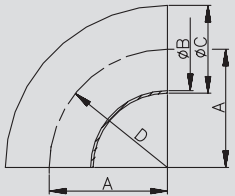

Schweißbogen
Zoll 45°

welding bend
inch 45°

Art.-Nr. 32621-

DN	A	B	C	D	E	Gew.	AISI 304L-1.4307				AISI 316L-1.4404			
							Art.-Nr.	Preis	Art.-Nr.	Preis	Art.-Nr.	Preis	Art.-Nr.	Preis
mm	mm	mm	mm	mm	mm	kg	poliert	EUR	matt	EUR	poliert	EUR	matt	EUR
1"	18,0	22,9	25,4	27,5		0,040	-1001	8,30	-1002	5,10	-1003	11,40	-1004	8,30
1,5"	30,0	35,1	38,1	45,0		0,120	-1121	11,30	-1122	6,60	-1123	17,25	-1124	11,50
2"	46,0	47,8	50,8	67,5		0,190	-2001	14,00	-2002	7,50	-2003	20,00	-2004	13,85
2,5"	57,0	60,2	63,5	82,5		0,290	-2121	19,95	-2122	11,25	-2123	30,30	-2124	19,60
3"	65,5	72,8	76,1	95,0		0,540	-3001	29,95	-3002	15,85	-3003	43,00	-3004	23,40
4"	93,5	97,4	101,6	133,5		0,620	-4001	60,50	-4002	30,95	-4003	77,45	-4004	43,35

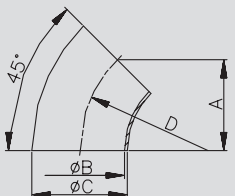

3.03 Walz- und Schweißbögen

3.03 expanding and welding bend

Art.-Nr. 33300-							AISI 304L-1.4307				AISI 316L-1.4404			
DN	A	B	C	D	E	Gew.	Art.-Nr.	Preis	Art.-Nr.	Preis	Art.-Nr.	Preis	Art.-Nr.	Preis
mm	mm	mm	mm	mm	mm	kg	poliert	EUR	wb	EUR	poliert	EUR	wb	EUR
10	38,0	12,0	9,0	12,0		0,025	-0101	6,85	-0101001	5,70	-0103	10,30	-0103001	8,40
15	47,0	12,0	15,0	18,0		0,050	-0151	9,00	-0151001	6,40	-0153	13,50	-0153001	11,00
20	52,0	12,0	19,0	22,0		0,070	-0201	9,70	-0201001	6,95	-0203	14,60	-0203001	11,80
25	70,0	20,0	25,0	28,0		0,110	-0251	7,25	-0251001	5,95	-0253	10,75	-0253001	8,85
32	78,0	23,0	31,0	34,0		0,150	-0321	8,90	-0321001	6,90	-0323	12,90	-0323001	10,50
40	85,0	25,0	37,0	40,0		0,210	-0401	9,80	-0401001	7,80	-0403	14,70	-0403001	12,10
50	97,0	27,0	49,0	52,0		0,280	-0501	12,20	-0501001	9,40	-0503	18,45	-0503001	14,85
65	110,0	30,0	66,0	70,0		0,570	-0651	18,25	-0651001	13,80	-0653	27,50	-0653001	22,15
80	118,0	28,0	81,0	85,0		0,790	-0801	51,00	-0801001	37,05	-0803	74,65	-0803001	61,25
100	140,0	40,0	100,0	104,0		1,200	-1001	65,50	-1001001	50,05	-1003	80,55	-1003001	69,15

wb: walzblank
matt gestrahlt auf Anfrage

wb: bright-rolled
mat blasted on inquiry

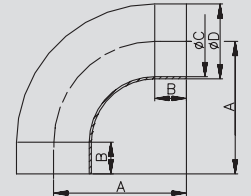

**Walzbogen
DIN 90°**
**expanding bend
DIN 90°**

Art.-Nr. 33320-							AISI 304L-1.4307				AISI 316L-1.4404			
DN	A	B	C	D	E	Gew.	Art.-Nr.	Preis	Art.-Nr.	Preis	Art.-Nr.	Preis	Art.-Nr.	Preis
mm	mm	mm	mm	mm	mm	kg	poliert	EUR	wb	EUR	poliert	EUR	wb	EUR
10	51,0	25,0	10,0	13,0		0,040	-0101	21,30	-0101001	19,30	-0103	25,00	-0103001	23,00
15	60,0	25,0	16,0	19,0		0,070	-0151	21,30	-0151001	19,30	-0153	25,20	-0153001	23,20
20	65,0	25,0	20,0	23,0		0,091	-0201	21,30	-0201001	19,20	-0203	30,00	-0203001	28,00
25	90,0	40,0	26,0	29,0		0,160	-0251	28,00	-0251001	26,00	-0253	35,50	-0253001	33,50
32	95,0	40,0	32,0	35,0		0,209	-0321	30,80	-0321001	28,80	-0323	38,00	-0323001	36,00
40	100,0	40,0	38,0	41,0		0,254	-0401	35,80	-0401001	32,80	-0403	43,50	-0403001	40,50
50	110,0	40,0	50,0	53,0		0,366	-0501	38,90	-0501001	35,80	-0503	47,00	-0503001	43,90
65	120,0	40,0	66,0	70,0		0,701	-0651	44,70	-0651001	39,90	-0653	56,50	-0653001	51,70
80	145,0	55,0	81,0	85,0		1,045	-0801	60,30	-0801001	50,60	-0803	75,10	-0803001	65,40
100	155,0	55,0	100,0	104,0		1,363	-1001	67,50	-1001001	57,60	-1003	93,10	-1003001	83,20
125	245,0	57,5	125,0	129,0		2,600	-1251	172,20	-1251001	156,20	-1253	221,90	-1253001	205,90

wb: walzblank
matt gestrahlt auf Anfrage

wb: bright-rolled
mat blasted on inquiry

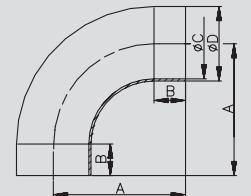

**Schweißbogen
DIN 11852-BL 90°**
**welding bend
DIN 11852-BL 90°**

Art.-Nr. 33322-							AISI 304L-1.4307				AISI 316L-1.4404			
DN	A	B	C	D	E	Gew.	Art.-Nr.	Preis	Art.-Nr.	Preis	Art.-Nr.	Preis	Art.-Nr.	Preis
mm	mm	mm	mm	mm	mm	kg	poliert	EUR	wb	EUR	poliert	EUR	wb	EUR
10	35,8	13,0	10,0	26,0	25,0	0,040	-0101	(+)	-0101001	(+)	-0103	(+)	-0103001	(+)
15	39,5	19,0	16,0	35,0	25,0	0,060	-0151	(+)	-0151001	(+)	-0153	(+)	-0153001	(+)
20	41,6	23,0	20,0	40,0	25,0	0,080	-0201	(+)	-0201001	(+)	-0203	(+)	-0203001	(+)
25	60,7	29,0	26,0	50,0	40,0	0,120	-0251	(+)	-0251001	(+)	-0253	(+)	-0253001	(+)
32	62,8	35,0	32,0	55,0	40,0	0,160	-0321	(+)	-0321001	(+)	-0323	(+)	-0323001	(+)
40	64,9	41,0	38,0	60,0	40,0	0,195	-0401	(+)	-0401001	(+)	-0403	(+)	-0403001	(+)
50	69,0	53,0	50,0	70,0	40,0	0,280	-0501	(+)	-0501001	(+)	-0503	(+)	-0503001	(+)
65	73,1	70,0	66,0	80,0	40,0	0,580	-0651	(+)	-0651001	(+)	-0653	(+)	-0653001	(+)
80	92,3	85,0	81,0	90,0	55,0	0,900	-0801	(+)	-0801001	(+)	-0803	(+)	-0803001	(+)
100	96,4	104,0	100,0	100,0	55,0	1,120	-1001	(+)	-1001001	(+)	-1003	(+)	-1003001	(+)
125	135,2	129,0	125,0	187,5	57,5	1,650	-1251	(+)	-1251001	(+)	-1253	(+)	-1253001	(+)

wb: walzblank
matt gestrahlt auf Anfrage

wb: bright-rolled
mat blasted on inquiry

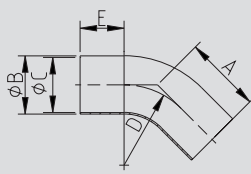

**Schweißbogen
DIN 11852-BL 45°**
**welding bend
DIN 11852-BL 45°**

3.04 Schweiß- und Clampbogen

3.04 welding bend and clamp bend

**Schweißbogen
5D DIN 90°**
**welding bend
5D DIN 90°**

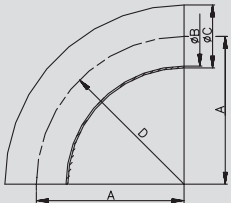

Art.-Nr. 33306-							AISI 304L-1.4307				AISI 316L-1.4404			
DN	A	B	C	D	E	Gew.	Art.-Nr.	Preis	Art.-Nr.	Preis	Art.-Nr.	Preis	Art.-Nr.	Preis
mm	mm	mm	mm	mm	mm	kg	poliert	EUR	wb	EUR	poliert	EUR	wb	EUR
10	35,0	9,0	12,0	35,0		0,021					-0103	32,85	-0103001	29,85
15	50,0	15,0	18,0	50,0		0,048					-0153	33,15	-0153001	30,40
20	60,0	19,0	22,0	60,0		0,060	-0201	31,20	-0201001	28,20	-0203	36,45	-0203001	33,40
25	65,0	25,0	28,0	65,0		0,100	-0251	25,75	-0251001	22,95	-0253	29,30	-0253001	25,15
32	75,0	31,0	34,0	75,0		0,110	-0321	35,60	-0321001	33,00	-0323	41,55	-0323001	38,95
40	95,0	37,0	40,0	95,0		0,190	-0401	42,95	-0401001	36,90	-0403	52,90	-0403001	47,00
50	125,0	49,0	52,0	125,0		0,370	-0501	47,55	-0501001	40,65	-0503	58,00	-0503001	51,10
65	160,0	66,0	70,0	160,0		0,780	-0651	63,75	-0651001	58,80	-0653	73,00	-0653001	63,25
80	200,0	81,0	85,0	200,0		1,170	-0801	73,60	-0801001	66,40	-0803	81,60	-0803001	70,60
100	250,0	100,0	104,0	250,0		1,820	-1001	109,80	-1001001	97,70	-1003	114,55	-1003001	102,05
125	312,5	125,0	129,0	312,5		3,100	-1251	333,00	-1251001	269,00	-1253	352,00	-1253001	288,00

DN 65 - 125 gem. DIN 11852-BA5
wb: walzblank, matt gestrahlt auf Anfrage

DN 65 - 125 acc. DIN 11852-EA5
wb: bright-rolled, mat blasted on inquiry

**Schweißbogen
DIN 11852-BA5 90°**
**welding bend
DIN 11852-BA5 90°**

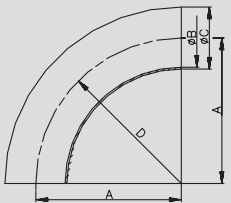

Art.-Nr. 33326-							AISI 304L-1.4307				AISI 316L-1.4404			
DN	A	B	C	D	E	Gew.	Art.-Nr.	Preis	Art.-Nr.	Preis	Art.-Nr.	Preis	Art.-Nr.	Preis
mm	mm	mm	mm	mm	mm	kg	poliert	EUR	wb	EUR	poliert	EUR	wb	EUR
10	40,0	10,0	13,0	40,0		0,026					-0103	33,40	-0103001	30,40
15	50,0	16,0	19,0	50,0		0,052					-0153	35,60	-0153001	32,40
20	55,0	20,0	23,0	55,0		0,069	-0201	38,20	-0201001	34,90	-0203	39,00	-0203001	35,70
25	65,0	26,0	29,0	65,0		0,145	-0251	41,15	-0251001	37,15	-0253	42,25	-0253001	38,25
32	75,0	32,0	35,0	75,0		0,148	-0321	42,90	-0321001	38,40	-0323	45,00	-0323001	40,50
40	95,0	38,0	41,0	95,0		0,294	-0401	50,25	-0401001	45,25	-0403	52,85	-0403001	47,85
50	125,0	50,0	53,0	125,0		0,380	-0501	64,40	-0501001	56,40	-0503	67,40	-0503001	59,40

DN 65 - 125 siehe Art.-Nr. 33306
wb: walzblank, matt gestrahlt auf Anfrage

DN 65 - 125 see item-no. 33306
wb: bright-rolled, mat blasted on inquiry

Bogen DIN CC 90°
**bend
DIN clamp/clamp 90°**

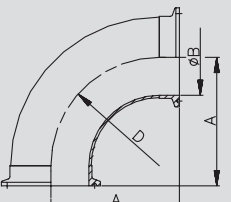

Art.-Nr. 34400-							AISI 304/304L-1.4301/1.4307				AISI 316L-1.4404			
DN	A	B	C	D	E	Gew.	Art.-Nr.	Preis	Art.-Nr.	Preis	Art.-Nr.	Preis	Art.-Nr.	Preis
mm	mm	mm	mm	mm	mm	kg	poliert	EUR	matt	EUR	poliert	EUR	matt	EUR
10	44,0	10,0		26,0		0,080	-0101	47,55	-0102	44,25	-0103	54,45	-0104	50,70
15	53,0	16,0		35,0		0,100	-0151	49,50	-0152	46,05	-0153	57,35	-0154	53,45
20	58,0	20,0		40,0		0,120	-0201	50,15	-0202	46,75	-0203	58,40	-0204	54,40
25	63,0	26,0		50,0		0,190	-0251	41,05	-0252	38,25	-0253	46,80	-0254	43,60
32	68,0	32,0		55,0		0,240	-0321	51,45	-0322	47,95	-0323	61,65	-0324	57,45
40	73,0	38,0		60,0		0,260	-0401	45,90	-0402	42,75	-0403	53,30	-0404	49,60
50	83,0	50,0		70,0		0,310	-0501	51,65	-0502	48,10	-0503	60,10	-0504	55,95
65	93,0	66,0		80,0		0,600	-0651	68,60	-0652	63,90	-0653	79,75	-0654	74,25
80	103,0	81,0		90,0		1,000	-0801	90,80	-0802	84,55	-0803	110,10	-0804	102,50
100	113,0	100,0		100,0		1,610	-1001	125,50	-1002	116,85	-1003	147,35	-1004	137,20

3.05 Bogen mit Anschlüssen

3.05 bend with sockets

Art.-Nr. 34401-							AISI 304/304L-1.4301/1.4307				AISI 316L-1.4404			
DN	A	B	C	D	E	Gew.	Art.-Nr.	Preis	Art.-Nr.	Preis	Art.-Nr.	Preis	Art.-Nr.	Preis
mm	mm	mm	mm	mm	mm	kg	poliert	EUR	matt	EUR	poliert	EUR	matt	EUR
1"	40,5	22,9		27,5		0,180	-1001	49,05	-1002	45,65	-1003	55,50	-1004	51,70
1,5"	58,0	35,1		45,0		0,270	-1121	55,30	-1122	51,50	-1123	64,30	-1124	59,85
2"	80,5	47,8		67,5		0,330	-2001	63,50	-2002	59,15	-2003	77,00	-2004	71,70
2,5"	95,5	60,2		82,5		0,490	-2121	84,25	-2122	78,45	-2123	99,90	-2124	93,00
3"	108,0	72,8		95,0		0,800	-3001	109,30	-3002	101,75	-3003	119,40	-3004	111,15
4"	146,5	97,4		133,5		1,500	-4001	148,75	-4002	138,50	-4003	170,50	-4004	158,75

Bogen Zoll CC 90°

bend inch clamp/clamp 90°

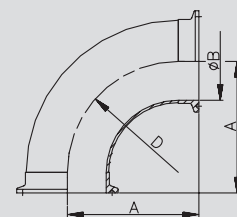

Art.-Nr. 35200-							AISI 304/304L-1.4301/1.4307				AISI 316L-1.4404			
DN	A	B	C	D	E	Gew.	Art.-Nr.	Preis	Art.-Nr.	Preis	Art.-Nr.	Preis	Art.-Nr.	Preis
mm	mm	mm	mm	mm	mm	kg	poliert	EUR	matt	EUR	poliert	EUR	matt	EUR
10	43,0	26,0	9,0	26,0	Rd28x1/8	0,040	-0101	20,50	-0102	19,10	-0103	26,65	-0104	24,80
15	52,0	35,0	15,0	35,0	Rd34x1/8	0,070	-0151	24,05	-0152	22,40	-0153	31,25	-0154	29,10
20	59,0	40,0	19,0	40,0	Rd44x1/6	0,130	-0201	25,95	-0202	24,15	-0203	33,70	-0204	31,35
25	72,0	50,0	25,0	50,0	Rd52x1/6	0,170	-0251	21,65	-0252	20,15	-0253	28,15	-0254	26,20
32	77,0	55,0	31,0	55,0	Rd58x1/6	0,220	-0321	23,55	-0322	21,95	-0323	30,65	-0324	28,50
40	82,0	60,0	37,0	60,0	Rd65x1/6	0,250	-0401	26,60	-0402	24,75	-0403	34,60	-0404	32,20
50	93,0	70,0	49,0	70,0	Rd78x1/6	0,470	-0501	30,95	-0502	28,80	-0503	40,20	-0504	37,45
65	105,0	80,0	66,0	80,0	Rd95x1/6	0,710	-0651	42,05	-0652	39,15	-0653	54,70	-0654	50,95
80	115,0	90,0	81,0	90,0	Rd110x1/4	0,930	-0801	68,10	-0802	63,40	-0803	102,15	-0804	95,10
100	130,0	100,0	100,0	100,0	Rd130x1/4	1,250	-1001	97,60	-1002	90,85	-1003	146,35	-1004	136,25
125	223,0	187,5	125,0	187,5	Rd160x1/4	2,900	-1251	229,40	-1252	213,55	-1253	263,15	-1254	245,00
150	265,0	225,0	150,0	225,0	Rd190x1/4	4,280	-1501	321,20	-1502	299,05	-1503	438,90	-1504	408,65

Bogen GS DIN 90°

bend DIN male/weld.end DIN 90°

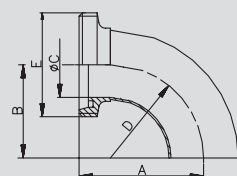

Rd: Rundgewinde

Rd: round thread

Art.-Nr. 35500-							AISI 304/304L-1.4301/1.4307				AISI 316L-1.4404			
DN	A	B	C	D	E	Gew.	Art.-Nr.	Preis	Art.-Nr.	Preis	Art.-Nr.	Preis	Art.-Nr.	Preis
mm	mm	mm	mm	mm	mm	kg	poliert	EUR	matt	EUR	poliert	EUR	matt	EUR
10	43,0	9,0		26,0	Rd28x1/8	0,075	-0101	31,20	-0102	29,05	-0103	40,60	-0104	37,80
15	52,0	15,0		35,0	Rd34x1/8	0,120	-0151	36,60	-0152	34,10	-0153	47,70	-0154	44,40
20	59,0	19,0		40,0	Rd44x1/6	0,200	-0201	40,80	-0202	37,95	-0203	53,00	-0204	49,35
25	72,0	25,0		50,0	Rd52x1/6	0,245	-0251	33,85	-0252	31,55	-0253	44,15	-0254	41,10
32	77,0	31,0		55,0	Rd58x1/6	0,310	-0321	36,60	-0322	34,10	-0323	47,60	-0324	44,35
40	82,0	37,0		60,0	Rd65x1/6	0,400	-0401	39,90	-0402	37,15	-0403	51,85	-0404	48,25
50	93,0	49,0		70,0	Rd78x1/6	0,500	-0501	46,75	-0502	43,55	-0503	60,80	-0504	56,60
65	105,0	66,0		80,0	Rd95x1/6	0,900	-0651	63,35	-0652	59,00	-0653	82,50	-0654	76,80
80	115,0	81,0		90,0	Rd110x1/4	1,380	-0801	98,80	-0802	92,00	-0803	148,00	-0804	137,80
100	130,0	100,0		100,0	Rd130x1/4	2,320	-1001	139,90	-1002	130,25	-1003	209,85	-1004	195,40
125	223,0	125,0		187,5	Rd160x1/4	3,820	-1251	(+)	-1252	(+)	-1253	(+)	-1254	(+)
150	265,0	150,0		225,0	Rd190x1/4	5,840	-1501	(+)	-1502	(+)	-1503	(+)	-1504	(+)

Bogen GG DIN 90°

bend DIN male/male DIN 90°

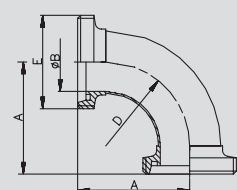

Rd: Rundgewinde

Rd: round thread

(+) Preis auf Anfrage

(+) price on inquiry

3.06 Bogen mit Anschlüssen

3.06 bend with sockets

Bogen GG DIN 45°

**bend
male/male DIN 45°**

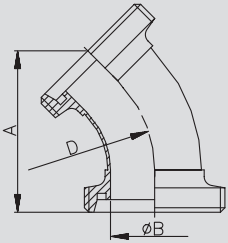

Art.-Nr. 35502-

DN	A	B	C	D	E	Gew.
mm	mm	mm	mm	mm	mm	kg
10	38,5	9,0		26,0		0,073
15	44,0	15,0		35,0		0,104
20	48,5	19,0		40,0		0,173
25	59,0	25,0		50,0		0,250
32	62,5	31,0		55,0		0,280
40	66,0	37,0		60,0		0,340
50	74,5	49,0		70,0		0,410
65	83,5	66,0		80,0		0,700
80	90,5	81,0		90,0		1,120
100	102,0	100,0		100,0		1,730
125	170,0	125,0		187,5		2,830
150	202,0	150,0		225,0		4,480

AISI 304/304L-1.4301/1.4307

Art.-Nr.	Preis	Art.-Nr.	Preis
poliert	EUR	matt	EUR
-0101	30,20	-0102	28,05
-0151	35,55	-0152	33,05
-0201	39,70	-0202	36,85
-0251	32,70	-0252	30,40
-0321	35,30	-0322	32,80
-0401	37,95	-0402	35,20
-0501	44,25	-0502	41,05
-0651	59,60	-0652	55,25
-0801	91,65	-0802	84,85
-1001	129,90	-1002	120,25
-1251	(+)	-1252	(+)
-1501	(+)	-1502	(+)

AISI 316L-1.4404

Art.-Nr.	Preis	Art.-Nr.	Preis
poliert	EUR	matt	EUR
-0103	39,45	-0104	36,65
-0153	46,60	-0154	43,30
-0203	51,75	-0204	48,10
-0253	42,70	-0254	39,65
-0323	45,85	-0324	42,60
-0403	49,15	-0404	45,55
-0503	57,60	-0504	53,40
-0653	77,00	-0654	71,30
-0803	138,00	-0804	127,80
-1003	197,20	-1004	182,75
-1253	(+)	-1254	(+)
-1503	(+)	-1504	(+)

**Bogen KG
DIN 90°**

**bend
liner/male DIN 90°**

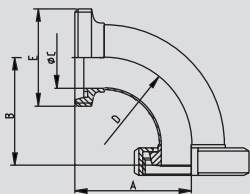

Art.-Nr. 35600-

DN	A	B	C	D	E	Gew.
mm	mm	mm	mm	mm	mm	kg
10	43,0	39,0	9,0	26,0	Rd28x1/8	0,130
15	52,0	48,0	15,0	35,0	Rd34x1/8	0,200
20	59,0	53,0	19,0	40,0	Rd44x1/6	0,280
25	72,0	65,0	25,0	50,0	Rd52x1/6	0,400
32	77,0	70,0	31,0	55,0	Rd58x1/6	0,510
40	82,0	75,0	37,0	60,0	Rd65x1/6	0,630
50	93,0	86,0	49,0	70,0	Rd78x1/6	0,870
65	105,0	97,0	66,0	80,0	Rd95x1/6	1,440
80	115,0	107,0	81,0	90,0	Rd110x1/4	1,900
100	130,0	120,0	100,0	100,0	Rd130x1/4	2,610
125	223,0	211,0	125,0	187,5	Rd160x1/4	4,950
150	265,0	252,0	150,0	225,0	Rd190x1/4	7,250

AISI 304/304L-1.4301/1.4307

Art.-Nr.	Preis	Art.-Nr.	Preis
poliert	EUR	matt	EUR
-0101	35,65	-0102	33,20
-0151	42,05	-0152	39,15
-0201	43,45	-0202	40,45
-0251	40,60	-0252	37,80
-0321	44,60	-0322	41,55
-0401	47,60	-0402	44,35
-0501	56,90	-0502	53,00
-0651	78,95	-0652	73,50
-0801	121,90	-0802	113,50
-1001	178,05	-1002	165,75
-1251	(+)	-1252	(+)
-1501	(+)	-1502	(+)

AISI 316L-1.4404

Art.-Nr.	Preis	Art.-Nr.	Preis
poliert	EUR	matt	EUR
-0103	46,40	-0104	43,20
-0153	54,70	-0154	50,95
-0203	56,55	-0204	52,65
-0253	52,80	-0254	49,15
-0323	58,10	-0324	54,10
-0403	61,90	-0404	57,65
-0503	73,95	-0504	68,85
-0653	102,65	-0654	95,55
-0803	182,75	-0804	170,15
-1003	267,00	-1004	248,60
-1253	(+)	-1254	(+)
-1503	(+)	-1504	(+)

Rd: Rundgewinde

Rd: round thread

**Bogen KG
DIN 45°**

**bend
liner/male DIN 45°**

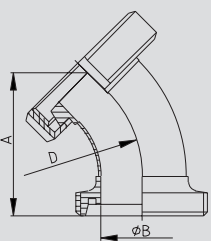

Art.-Nr. 35602-

DN	A	B	C	D	E	Gew.
mm	mm	mm	mm	mm	mm	kg
10	38,5	9,0		26,0		0,090
15	44,0	15,0		35,0		0,124
20	48,5	19,0		40,0		0,215
25	59,0	25,0		50,0		0,360
32	62,5	31,0		55,0		0,430
40	66,0	37,0		60,0		0,530
50	74,5	50,0		70,0		0,560
65	83,5	66,0		80,0		1,170
80	90,5	81,0		90,0		1,700
100	102,0	100,0		100,0		2,470
125	170,0	125,0		187,5		3,960
150	202,0	150,0		225,0		5,890

AISI 304/304L-1.4301/1.4307

Art.-Nr.	Preis	Art.-Nr.	Preis
poliert	EUR	matt	EUR
-0101	34,65	-0102	32,20
-0151	41,00	-0152	38,10
-0201	42,35	-0202	39,35
-0251	39,50	-0252	36,70
-0321	43,30	-0322	40,25
-0401	45,65	-0402	42,40
-0501	54,40	-0502	50,50
-0651	75,20	-0652	69,75
-0801	114,75	-0802	106,35
-1001	168,05	-1002	155,75
-1251	(+)	-1252	(+)
-1501	(+)	-1502	(+)

AISI 316L-1.4404

Art.-Nr.	Preis	Art.-Nr.	Preis
poliert	EUR	matt	EUR
-0103	45,25	-0104	42,05
-0153	53,60	-0154	49,85
-0203	55,30	-0204	51,40
-0253	51,35	-0254	47,70
-0323	56,35	-0324	52,35
-0403	59,20	-0404	54,95
-0503	70,75	-0504	65,65
-0653	97,15	-0654	90,05
-0803	172,75	-0804	160,15
-1003	254,35	-1004	235,95
-1253	(+)	-1254	(+)
-1503	(+)	-1504	(+)

(+) Preis auf Anfrage

(+) price on inquiry

3.07 Bogen mit Anschlüssen

3.07 bend with sockets

Art.-Nr. 36200-							AISI 304/304L-1.4301/1.4307				AISI 316L-1.4404			
DN	A	B	C	D	E	Gew.	Art.-Nr.	Preis	Art.-Nr.	Preis	Art.-Nr.	Preis	Art.-Nr.	Preis
mm	mm	mm	mm	mm	mm	kg	poliert	EUR	matt	EUR	poliert	EUR	matt	EUR
10	39,0	26,0	9,0	26,0		0,030	-0101	15,30	-0102	14,25	-0103	19,80	-0104	18,45
15	48,0	35,0	15,0	35,0		0,050	-0151	18,35	-0152	17,10	-0153	23,90	-0154	22,25
20	53,0	40,0	19,0	40,0		0,125	-0201	20,90	-0202	19,50	-0203	27,20	-0204	25,35
25	65,0	50,0	25,0	50,0		0,150	-0251	19,40	-0252	18,05	-0253	25,25	-0254	23,50
32	70,0	55,0	31,0	55,0		0,190	-0321	21,40	-0322	19,95	-0323	27,90	-0324	25,95
40	75,0	60,0	37,0	60,0		0,220	-0401	24,35	-0402	22,65	-0403	31,55	-0404	29,40
50	86,0	70,0	49,0	70,0		0,330	-0501	28,75	-0502	26,75	-0503	37,35	-0504	34,80
65	97,0	80,0	66,0	80,0		0,610	-0651	38,65	-0652	36,00	-0653	50,25	-0654	46,80
80	107,0	90,0	81,0	90,0		0,790	-0801	61,00	-0802	56,80	-0803	91,55	-0804	85,25
100	120,0	100,0	100,0	100,0		1,110	-1001	93,90	-1002	87,45	-1003	140,90	-1004	131,20
125	211,0	187,5	125,0	187,5		2,580	-1251	(+)	-1252	(+)	-1253	(+)	-1254	(+)
150	252,0	225,0	150,0	225,0		3,510	-1501	(+)	-1502	(+)	-1503	(+)	-1504	(+)

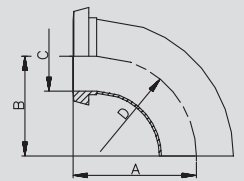

**Bogen KS
DIN 90°**

**bend
liner/weld.end
DIN 90°**

Art.-Nr. 36600-							AISI 304/304L-1.4301/1.4307				AISI 316L-1.4404			
DN	A	B	C	D	E	Gew.	Art.-Nr.	Preis	Art.-Nr.	Preis	Art.-Nr.	Preis	Art.-Nr.	Preis
mm	mm	mm	mm	mm	mm	kg	poliert	EUR	matt	EUR	poliert	EUR	matt	EUR
10	39,0	9,0		26,0		0,180	-0101	39,20	-0102	36,50	-0103	50,95	-0104	47,45
15	48,0	15,0		35,0		0,220	-0151	46,95	-0152	43,70	-0153	61,05	-0154	56,85
20	53,0	19,0		40,0		0,370	-0201	47,70	-0202	44,40	-0203	62,05	-0204	57,75
25	65,0	25,0		50,0		0,535	-0251	47,60	-0252	44,35	-0253	61,90	-0254	57,65
32	70,0	31,0		55,0		0,650	-0321	53,20	-0322	49,50	-0323	69,10	-0324	64,35
40	75,0	37,0		60,0		0,755	-0401	56,30	-0402	52,40	-0403	73,20	-0404	68,15
50	86,0	49,0		70,0		1,000	-0501	67,00	-0502	62,35	-0503	87,15	-0504	81,15
65	97,0	66,0		80,0		1,835	-0651	94,85	-0652	88,30	-0653	123,25	-0654	114,75
80	107,0	81,0		90,0		2,650	-0801	144,00	-0802	134,10	-0803	216,05	-0804	201,15
100	120,0	100,0		100,0		4,100	-1001	215,10	-1002	200,30	-1003	322,70	-1004	300,45
125	211,0	125,0		187,5		6,080	-1251	(+)	-1252	(+)	-1253	(+)	-1254	(+)
150	252,0	150,0		225,0		8,660	-1501	(+)	-1502	(+)	-1503	(+)	-1504	(+)

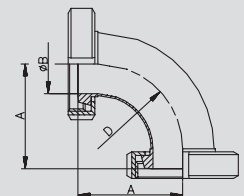

**Bogen KK
DIN 90°**

**bend
liner/liner DIN 90°**

Art.-Nr. 36602-							AISI 304/304L-1.4301/1.4307				AISI 316L-1.4404			
DN	A	B	C	D	E	Gew.	Art.-Nr.	Preis	Art.-Nr.	Preis	Art.-Nr.	Preis	Art.-Nr.	Preis
mm	mm	mm	mm	mm	mm	kg	poliert	EUR	matt	EUR	poliert	EUR	matt	EUR
10	38,5	9,0		26,0		0,177	-0101	38,20	-0102	35,50	-0103	49,80	-0104	46,30
15	44,0	15,0		35,0		0,208	-0151	45,90	-0152	42,65	-0153	59,95	-0154	55,75
20	48,5	19,0		40,0		0,357	-0201	46,60	-0202	43,30	-0203	60,80	-0204	56,50
25	59,0	25,0		50,0		0,520	-0251	46,45	-0252	43,20	-0253	60,45	-0254	56,20
32	62,5	31,0		55,0		0,570	-0321	51,90	-0322	48,20	-0323	67,35	-0324	62,60
40	66,0	37,0		60,0		0,740	-0401	54,35	-0402	50,45	-0403	70,50	-0404	65,45
50	74,5	49,0		70,0		0,970	-0501	64,50	-0502	59,85	-0503	83,95	-0504	77,95
65	83,5	66,0		80,0		1,660	-0651	91,10	-0652	84,55	-0653	117,75	-0654	109,25
80	90,5	81,0		90,0		2,340	-0801	136,85	-0802	126,95	-0803	206,05	-0804	191,15
100	102,0	100,0		100,0		3,515	-1001	205,10	-1002	190,30	-1003	310,05	-1004	287,80
125	170,0	125,0		187,5		5,090	-1251	(+)	-1252	(+)	-1253	(+)	-1254	(+)
150	202,0	150,0		225,0		7,380	-1501	(+)	-1502	(+)	-1503	(+)	-1504	(+)

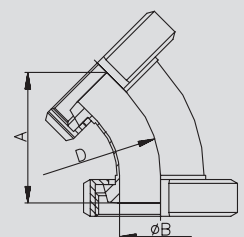

**Bogen KK
DIN 45°**

**bend
liner/liner DIN 45°**

(+) Preis auf Anfrage

(+) price on inquiry

3.08 Bogen 180°

3.08 bend 180°

**Schweißbogen
DIN 180°**

**welding bend
DIN 180°**

Art.-Nr. 38600-

AISI 304/304L-1.4301/1.4307

AISI 316L-1.4404

DN	A mm	B mm	C mm	D mm	E mm	Gew. kg	AISI 304/304L-1.4301/1.4307		AISI 316L-1.4404					
							Art.-Nr. poliert	Preis EUR	Art.-Nr. wb	Preis EUR	Art.-Nr. poliert	Preis EUR	Art.-Nr. wb	Preis EUR
10	52,0	9,0	12,0			0,030	-0101	29,20	-0101001	26,30	-0103	31,00	-0103001	28,55
15	68,0	15,0	18,0			0,070	-0151	29,80	-0151001	26,70	-0153	32,60	-0153001	30,00
20	76,0	19,0	22,0			0,100	-0201	34,90	-0201001	32,10	-0203	36,75	-0203001	33,85
25	100,0	25,0	28,0			0,160	-0251	35,80	-0251001	32,30	-0253	38,40	-0253001	35,30
32	110,0	31,0	34,0			0,220	-0321	38,20	-0321001	34,80	-0323	40,90	-0323001	37,80
40	120,0	37,0	40,0			0,280	-0401	42,75	-0401001	40,30	-0403	52,65	-0403001	48,85
50	140,0	49,0	52,0			0,420	-0501	53,60	-0501001	50,20	-0503	66,55	-0503001	61,50
65	160,0	66,0	70,0			0,890	-0651	75,70	-0651001	71,10	-0653	93,80	-0653001	88,70
80	180,0	81,0	85,0			1,220	-0801	97,15	-0801001	90,95	-0803	132,05	-0803001	122,55
100	200,0	100,0	104,0			1,640	-1001	138,30	-1001001	128,20	-1003	188,40	-1003001	168,90

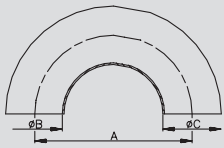

wb: walzblank
matt gestrahlt auf Anfrage
DN 65-100 gem. DIN 11852 - BS 180°

wb: bright-rolled
mat blasted on inquiry
DN 65-100 acc DIN 11852 - BS 180°

**Schweißbogen
DIN 11852-BS 180°**

**welding bend
DIN 11852-BS 180°**

Art.-Nr. 38620-

AISI 304/304L-1.4301/1.4307

AISI 316L-1.4404

DN	A mm	B mm	C mm	D mm	E mm	Gew. kg	AISI 304/304L-1.4301/1.4307		AISI 316L-1.4404					
							Art.-Nr. poliert	Preis EUR	Art.-Nr. wb	Preis EUR	Art.-Nr. poliert	Preis EUR	Art.-Nr. wb	Preis EUR
10	52,0	10,0	13,0			0,040	-0101	32,15	-0101001	28,95	-0103	34,10	-0103001	31,45
15	70,0	16,0	19,0			0,080	-0151	32,80	-0151001	29,40	-0153	35,90	-0153001	33,00
20	80,0	20,0	23,0			0,110	-0201	38,40	-0201001	35,35	-0203	40,45	-0203001	37,25
25	100,0	26,0	29,0			0,170	-0251	39,40	-0251001	35,55	-0253	42,25	-0253001	38,85
32	110,0	32,0	35,0			0,240	-0321	42,05	-0321001	38,30	-0323	44,70	-0323001	41,60
40	120,0	38,0	41,0			0,300	-0401	42,25	-0401001	39,55	-0403	52,15	-0403001	48,00
50	140,0	50,0	53,0			0,440	-0501	56,35	-0501001	52,60	-0503	70,00	-0503001	64,45

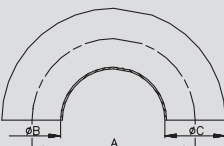

matt gestrahlt auf Anfrage
DN 65-100 siehe Art.-Nr. 38600

mat blasted on inquiry
DN 65-100 see item-no. 38600

**Bogen KK
DIN 180°**

**bend
liner/liner DIN 180°**

Art.-Nr. 38900-

AISI 304/304L-1.4301/1.4307

AISI 316L-1.4404

DN	A mm	B mm	C mm	D mm	E mm	Gew. kg	AISI 304/304L-1.4301/1.4307		AISI 316L-1.4404					
							Art.-Nr. poliert	Preis EUR	Art.-Nr. matt	Preis EUR	Art.-Nr. poliert	Preis EUR	Art.-Nr. matt	Preis EUR
10	52,0	9,0	39,0			0,186	-0101	53,45	-0102	49,20	-0103	69,55	-0104	64,00
15	68,0	15,0	48,0			0,228	-0151	61,55	-0152	56,65	-0153	80,10	-0154	73,65
20	76,0	19,0	53,0			0,400	-0201	62,50	-0202	57,50	-0203	81,25	-0204	74,75
25	100,0	25,0	65,0			0,510	-0251	73,35	-0252	67,50	-0253	95,40	-0254	87,80
32	110,0	31,0	70,0			0,755	-0321	80,00	-0322	73,60	-0323	104,05	-0324	95,70
40	120,0	37,0	75,0			0,920	-0401	92,40	-0402	85,35	-0403	119,75	-0404	110,60
50	140,0	49,0	86,0			1,150	-0501	110,00	-0502	101,40	-0503	142,90	-0504	131,75
65	160,0	66,0	97,0			2,210	-0651	156,80	-0652	145,00	-0653	203,30	-0654	188,00
80	180,0	81,0	107,0			3,160	-0801	231,55	-0802	213,80	-0803	345,75	-0804	319,15
100	200,0	100,0	120,0			5,720	-1001	319,95	-1002	282,10	-1003	474,60	-1004	417,75

